

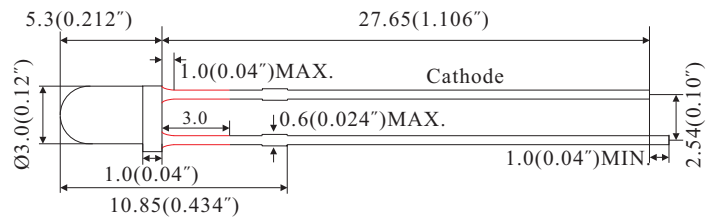

PACKAGE DIMENSION

TY-30UA3D45-600

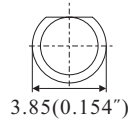

Selection Guide

| Part No. | Dice | | Lens Color | (If=20mA) | Viewing Angle |
|-----------------|--------------|--------------------|-----------------|------------|---------------|
| | Raw Material | Emitted Color | | TYP. (Mcd) | |
| TY-30UA3D45-600 | AlGaInP | Ultra Bright Amber | Yellow Diffused | 600 | 45° |

Absolute Maximum Ratings at TA=25°C

| Parameter | Symbol | Maximum Rating | Units |
|-----------------------------------|---------|---------------------|-------|
| Power Dissipation | PD | 72 | mW |
| Peak Forward Current ⁴ | IFP | 150 | mA |
| Forward Current | IF | 30 | mA |
| Reverse Voltage | VR | 5 | V |
| Capacitance | C | 45 | pF |
| Operating/Storage Temperature | TA/TSTG | -40°C to +85°C | |
| Lead Solder Temperature | TSOL | 260°C for 3 Seconds | |

Electrical / Optical Characteristics at TA=25°C

| Parameter | Symbol | TYP. | MAX. | Units | Test Condition |
|--------------------------|------------------|------|------|-------|----------------|
| Peak Wavelength | λ_{peak} | 611 | - | nm | IF=20mA |
| Dominant Wavelength | λ_D | 606 | - | nm | IF=20mA |
| Spectral Line Half-width | $\Delta\lambda$ | 20 | - | nm | IF=20mA |
| Forward Voltage | VF | 2.00 | 2.40 | V | IF=20mA |
| Reverse Current | IR | - | 10 | uA | VR=5V |

Notes:

1. All dimension are in millimeter (inches);
2. Tolerance is $\pm 0.25\text{mm}(0.01\text{'})$ unless otherwise specified;
3. Not recommend to solder within 3mm from the resin;
4. 1/10 Duty Cycle, 0.1ms Pulse Width.