

Supervisor can set and lock 2 common process temperatures
Custom designed Soldering Tips can be made on special request with MOQ.

BEST Price-N-Performance Soldering Station for fine pitch SMD and reliable leadfree soldering

Optional Solder Wire Feeder for higher production rate with everyday saving of recurring wastage of solder wire
Operator's one hand gets free and provides precise length of the solder wire to each joint
(standard type is for 0.8 mm dia Solder Wire)

Digital Temperature Display for SET & ACTUAL Temperatures

Digitized Pushbuttons for precise temperature control

Heavy Duty Stable Stand

Solder Feeder Station and attachment for Soldering Pencil

Note: Solder Wire is not part of supply

Dry Cleaner for leadfree soldering

Wet type Cleaning Sponge

2 Common Process Temperatures can be programmed

Push-to-Fit design of Soldering Tips for easy and quick interchanging

Lightweight Soldering Pencil



Model DSSLF04H is a Value-For-Money (VFM) Soldering Station with intelligent features as supervisor can program two most commonly used process temperatures for instant recalling during operation. He can lock limits of temperature range (i.e if he sets mode 01 or 11 then operator cannot go beyond 400°C). It simultaneously shows SET temperature and ACTUAL temperature. It also has in-built digital temperature offset calibration feature to meet ISO 9000 requirements. It also provides reliable soldering joints in lesser time (higher production rate) as thermal recovery is faster because of the unique design of Soldering Tips. It is specifically designed for fine pitch SMD and Lead-Free soldering jobs.

Specifications

- Power : 90 Watts
- Temperature Range : 100°C ~ 500°C
- Sleep Time (minutes) : 0~99 (adjustable)
- Temperature Stability : ± 2% of final value
- Tip to Ground Potential : < 2 mV
- Tip to Ground Resistance : < 2 ohm

Scope of Supply

- Power & Control Unit
- Soldering Tip
- Wet Cleaning Sponge
- Soldering Pencil
- Support Rack
- Dry Cleaner

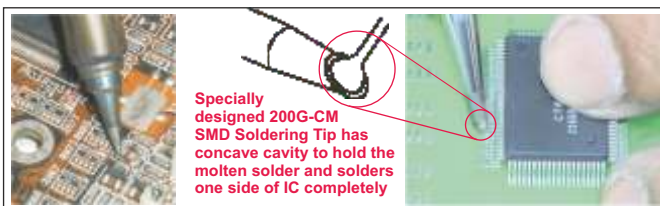

Specially designed 200G-CM SMD Soldering Tip has concave cavity to hold the molten solder and solders one side of IC completely

Leadfree and fine pitch bridgeless soldering of large size SMD ICs

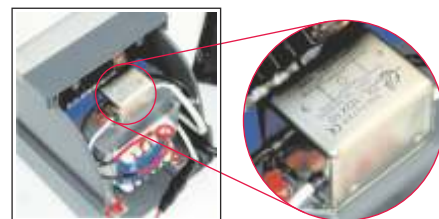

Special in-built EMI & Surge Suppression Filter suppresses mains power transients

shown trademarks are property of their respective owners.

While the information contained herein in, has been carefully compiled to the best of our knowledge, nothing is intended as representation and warranty on our part; and no statement shall be construed as recommendation to infringe any of existing patents. We accept no liability of whatsoever for any faults and errors in the information contained herein. Contents of this catalogue and specifications of the products, are subject to change without notice due to continuous improvements.

Supervisor can set and lock 2 common process temperatures

Custom designed Soldering Tips can be made on special request with MOQ.

Unique design of Soldering Pencil



Salient Features of Model DSSLF04H intelligent Leadfree 90 Watt Digital Soldering Station

Work Modes

Work modes provide temperature limits. Depending on the job, the supervisor can restrict the operator in a temperature range limits by choosing appropriate working mode. If customer has set 00 work mode then the maximum temperature will not go beyond 350°C

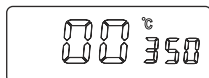

Mode	Temp. range	Alarm	Remark
00	100°C ~ 350°C	NO	Modes 10,11,12 & 13 have the alarm function. In these modes, the Soldering Station gives alarm when the difference between SET and ACTUAL temperature is more than 20°C
10		YES	
01	100°C ~ 400°C	NO	
11		YES	
02	100°C ~ 450°C	NO	
12		YES	
03	100°C ~ 500°C	NO	
13		YES	

Temperature Offset for Calibration

The Soldering Station has in-built digital temperature offset provision for calibration to meet ISO 9000 requirements. Customer does not need to open the Control Unit and adjust the trim pots.

Alarm Function

The Soldering Station has in-built alarm function to alert the operator. If there is more than 20°C temperature difference in SET and ACTUAL value then this alarm will alert the operator to check the Soldering Station. This alarm function is only functional within the specified Work Modes.

LCD Digital Display

Digital LCD Display for SET and ACTUAL temperatures at the same time and other various parameters.



Program 2 Common Process Temperatures

This Station has provision to set and save two frequently used process temperatures. User can set these as per his requirement & recall the same just by pressing corresponding 'F1' or 'F2' buttons.

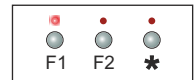

Supervisory Password Protection

The Soldering Station has provision of password locking. After password locking by the supervisor, the operators cannot change the pre-programmed process temperatures.

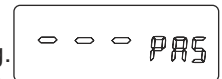

Sleep Time

Sleep time is very useful to prolong the life of Soldering Tips and Heating Elements of Soldering Pencil. The time is programmable from 0 to 99 minutes as per customer's requirement.

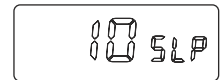

Error Messages

The Soldering Station has self diagnostic feature. It displays the fault of the Soldering Pencil. If the display shows H-E, it means the Heating Element or heater circuit is faulty. And if it shows S-E, means Temperature Sensor or sensor circuit is faulty.

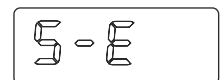
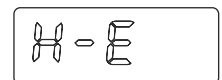

shown trademarks are property of their respective owners.

While the information contained herein in, has been carefully compiled to the best of our knowledge, nothing is intended as representation and warranty on our part; and no statement shall be construed as recommendation to infringe any of existing patents. We accept no liability of whatsoever for any faults and errors in the information contained herein. Contents of this catalogue and specifications of the products, are subject to change without notice due to continuous improvements.

Supervisor can set and lock 2 common process temperatures
Custom designed Soldering Tips can be made on special request with MOQ.

Wide variety of Soldering Tips available for different types of soldering applications

Description	Diagram	Width A (mm)	Thickness B (mm)	Model
Chisel Tip		0.8	0.5	200G-0.8D
		2.4	0.5	200G-2.4D
		4.2	0.5	200G-4.2D
Pointed Tip		Ø0.2	-	200G-I
Sloped Tip		Ø3	-	200G-3C
		Ø4	-	200G-4C
SMD Tip		3	-	200G-CM

Always select the best Soldering Tip

- For Gullwing type SMD soldering, use Soldering Tip 200G-CM
- For regular soldering, use Chisel type Soldering Tip 200G-2.4D
- For heavy mass soldering, use Soldering Tips 200G-3C, 200G-4C or 200G-4.2D
- Choose Soldering Tip that allows best access to solder joint. As a thumb rule, Tip should be selected with minimum possible length and maximum possible contact width. This allows faster heat transfer at lower temperature and results in higher production rate, lower consumption of Heating Element & Soldering Tips.

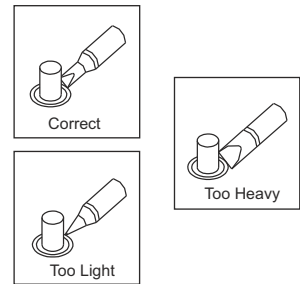

Avoid as far as possible use of pointed types & very long soldering tips as life of such tips is very less.

How to change Soldering Tips

Do not remove the Soldering Tip Locking Ring for changing the Soldering Tips

To change the Soldering Tip, hook the slot of the Soldering Tip into the pin provided on the stand and pull the handle. The Soldering Tip will come out very easily.

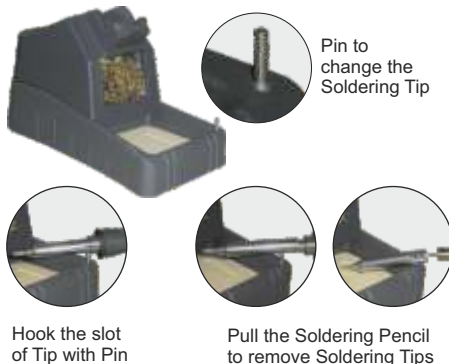

Assured availability, normally ex-stock of Spare Parts for Soldering Pencil

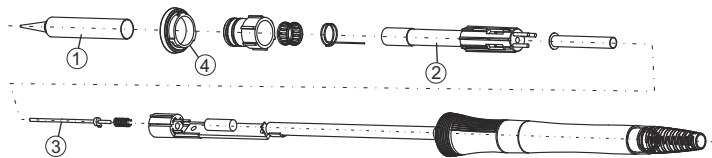

S.No.	Description	Remarks
1	Soldering Tip	Replace if worn out
2	Heating Element	Replace if display shows H-E
3	Sensor	Replace if display shows S-E
4	Tip Locking Ring	Whenever required

shown trademarks are property of their respective owners.

While the information contained herein in, has been carefully compiled to the best of our knowledge, nothing is intended as representation and warranty on our part; and no statement shall be construed as recommendation to infringe any of existing patents. We accept no liability of whatsoever for any faults and errors in the information contained herein. Contents of this catalogue and specifications of the products, are subject to change without notice due to continuous improvements.